

LEGEND:			
•	= TRAFFIC CONE	□	= EXISTING DRIVEWAY
⊕	= HIGH LEVEL WARNING DEVICE	⌵	= TYPE II BARRICADE
⏏	= PORTABLE SIGN	— r/c	= EXISTING RED CURB
P	= EXISTING SIGN	==	= DOUBLE YELLOW LANE LINES
⌵	= TYPE III BARRICADES	—	= EXISTING STRIPING
⌵	= TYPE III BARRICADES W/SIGN	⊙	= SIGNALIZED INTERSECTION
⏏	= FLASHING ARROW BOARD	→	= EXISTING LANE FLOW DIRECTION
⏏	= FLAGGER	→	= DIRECTION OF TRAFFIC FLOW
P.T.T.A.N.S.S. = POST TEMPORARY TOW AWAY NO STOPPING SIGNS			

# PHASE 1 OF 2

PROJECT DURATION: 3 DAYS

SCOPE OF WORK: TRENCH, PLACE FIBER

6TH ST. WATCH PAGE: 31

GRAND AVE. WATCH PAGE: 36

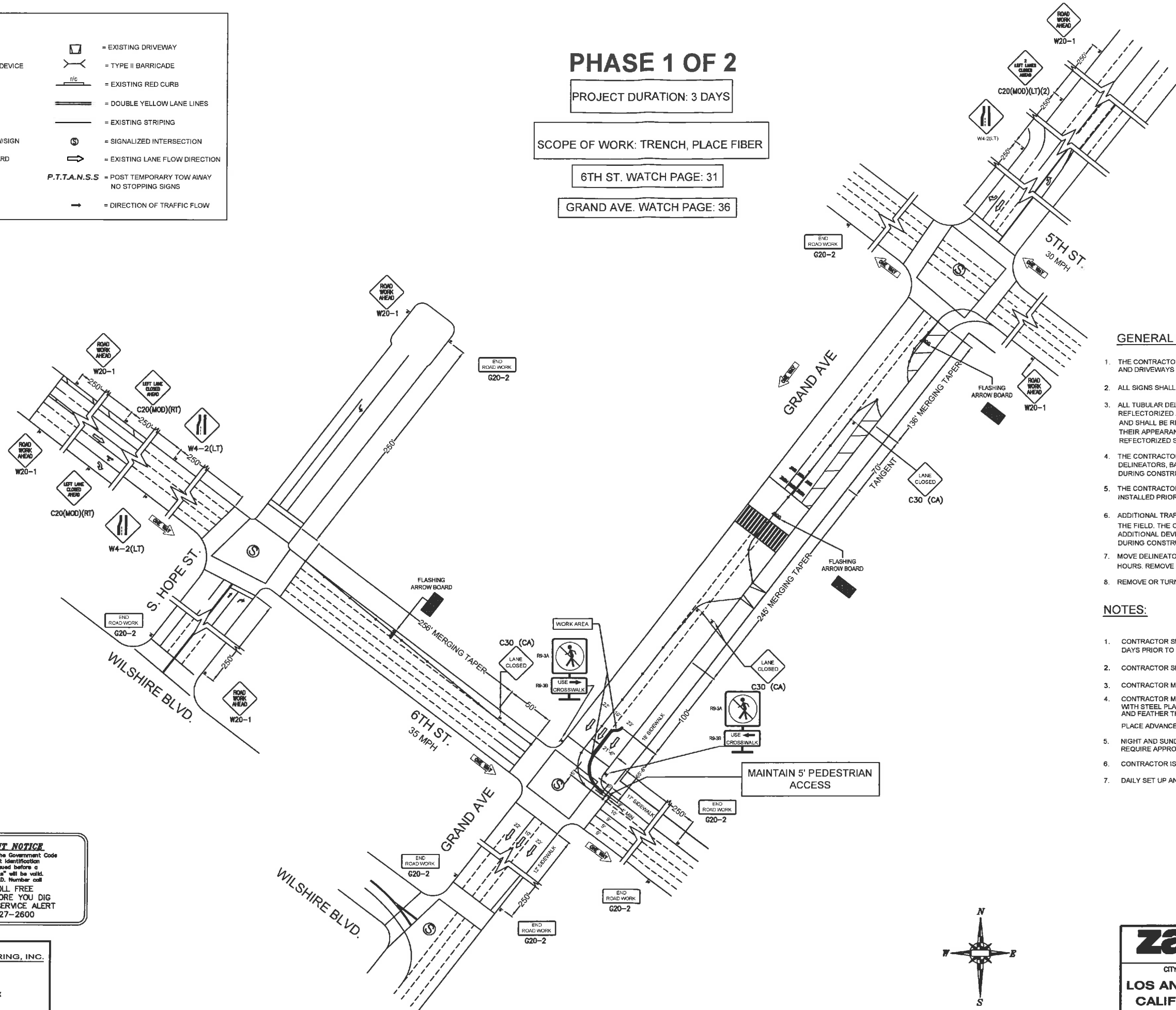

## TRAFFIC CONTROL PLANS

### GENERAL NOTES

1. THE CONTRACTOR SHALL PROVIDE FOR ACCESS TO ALL ADJACENT PROPERTIES, AND DRIVEWAYS AT ALL TIMES.
2. ALL SIGNS SHALL BE REFLECTORIZED AND STANDARD SIZE.
3. ALL TUBULAR DELINEATORS AND CONES SHALL BE 28" MINIMUM HEIGHT, REFLECTORIZED AND MAINTAINED ERECT IN THE INDICATED POSITION AT ALL TIMES, AND SHALL BE REPAIRED, REPLACED, OR CLEANED AS NECESSARY TO PRESERVE THEIR APPEARANCE AND CONTINUITY, AND SHALL INCLUDE A 12" HIGH INTENSITY REFLECTORIZED SLEEVE, IF USED DURING NIGHT-TIME HOURS.
4. THE CONTRACTOR SHALL MAINTAIN, ON A CONTINUOUS BASIS, ALL SIGNS, DELINEATORS, BARRICADES, ETC., TO ENSURE PROPER FLOW AND SAFETY OF TRAFFIC DURING CONSTRUCTION.
5. THE CONTRACTOR SHALL HAVE ALL SIGNS, DELINEATORS, BARRICADES, ETC., PROPERLY INSTALLED PRIOR TO COMMENCING CONSTRUCTION.
6. ADDITIONAL TRAFFIC CONTROLS, TRAFFIC SIGNS, OR BARRICADING MAY BE REQUIRED IN THE FIELD. THE CONTRACTOR SHALL BE RESPONSIBLE FOR THE PLACEMENT OF ANY ADDITIONAL DEVICES NECESSARY TO ASSURE SAFETY TO THE PUBLIC AT ALL TIMES DURING CONSTRUCTION.
7. MOVE DELINEATORS AND/OR CONES TO SIDEWALK DURING NON-WORKING HOURS. REMOVE BARRICADES ETC. FROM TRAVEL LANE.
8. REMOVE OR TURN OFF SIGNS DURING NON-WORK HOURS.

### NOTES:

1. CONTRACTOR SHALL CONTACT LADOT AT (213) 485-2298 A MINIMUM OF SEVEN (7) WORKING DAYS PRIOR TO CONSTRUCTION TO POST "TEMPORARY TOW AWAY NO STOPPING" SIGNS.
2. CONTRACTOR SHALL MAINTAIN ACCESS TO ALL DRIVEWAYS AT ALL TIMES.
3. CONTRACTOR MUST SET UP/TEAR DOWN DAILY.
4. CONTRACTOR MUST COVER TRENCH WITH STEEL PLATES AFTER WORKING HOURS AND FEATHER THE EDGE WITH AC AT A SLOPE OF 12:1. PLACE ADVANCE WARNING SIGNS FOR STEEL PLATES.
5. NIGHT AND SUNDAY WORK REQUIRE APPROVAL FROM THE POLICE COMMISSION.
6. CONTRACTOR IS RESPONSIBLE FOR ANY DAMAGES TO TRAFFIC SIGNAL EQUIPMENT.
7. DAILY SET UP AND TEAR DOWN OF LANE CLOSURE

**IMPORTANT NOTICE**  
 Section 4216/4217 of the Government Code requires a Dig Alert identification number to be issued before a "Permit to Excavate" will be valid. For your Dig Alert I.D. Number call CALL TOLL FREE 48 HOURS BEFORE YOU DIG UNDERGROUND SERVICE ALERT 1-800-227-2600

FJS CABLE ENGINEERING, INC.  
 www.vector1.net

14340 Bolen Chico Rd., Suite K  
 Westminister, CA 92683  
 TELE (714) 897-3793  
 FAX (714) 897-9593

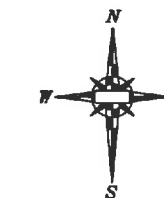

SCALE : 1" = 50'

TRAFFIC CONTROL PLAN		FILE NAME:
<b>zayo</b>		22323
CITY: <b>LOS ANGELES, CALIFORNIA</b>	LOCATION: <b>530 W. 6TH ST &amp; GRAND AVE.</b>	
DRAFTED: G.A. DATE: 03/27/15	THOMAS GUIDE NUMBER: 634.4-E	1 OF 2